



**AQUAMONIX**  
Measure. Monitor. Master.



# Irrigation Technology Price List

AU/NZ Edition  
September 2017  
V1.1

## **The Aquamonix Story**

*At Aquamonix, our mission is to improve the accuracy and efficiency of water use and monitoring in the environment. By doing this, we will save water and enhance land, water and environmental productivity. Our products are chosen by leading irrigation schemes, municipalities, urban irrigators, resource companies and farmers.*

*Talk to us to find out how you can get to know your water better.*

## **Measure**

*We have over 20 years of history and capability in the measurement of water quantity and quality. We have an installed base of over 30,000 flow meters throughout Australia's biggest irrigation schemes and municipalities. They exceed industry standards for accuracy and can be counted on to provide years of trouble and maintenance free operation. They represent the benchmark to which the industry aspires. In a similar vein, our water quality sensors can be relied upon to deliver industry leading accuracy and trouble-free operation in the harshest environments.*

## **Monitor**

*An Aquamonix Remote Monitoring System is a versatile platform for the management of remote meters, sensors and other equipment. Choose from Web Based or Closed Network, there is an Aquamonix Remote Monitoring Solution for every application.*

## **Master**

*It's easy to see why an Aquamonix Control Solution is the preferred choice for Certified Irrigation Designers, Landscape Architects, Irrigation System Installers, Turf Care Professionals, City Parks Managers, Farmers and Market Gardeners. With Aquamonix, there is a control solution for every application. Aquamonix understands explicitly what operators expect and have a keen sense of the challenges that they experience on a daily basis.*



The **Internet of Things** is a world where **things**, including **devices** and **sensors** are **connected** directly to the **internet** and are able to relay and share their data...



We like to call it the..., **Aquamonix of Things**....



We **imagined** a world where **smart** sensors, **smart** meters and **smart** actuators **connect** directly to your networks!

Welcome to the **AQUAMONIX OF THINGS** (AoT)

The **AoT** has three main parts...

### Measure

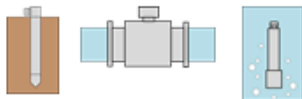

1

#### The THINGS....

Smart actuators, smart meters & smart sensors, for control and monitoring of water, soil & climate.

### Monitor

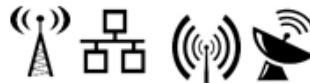

2

#### The DEVICES....

and networks that connect to them, Smart Data Gateways that use a wide array of communications.

### Master



3

#### The SYSTEMS....

and Algorithms that process and manage the data, Cloud Data Engines, SCADA Networks and Apps.

## Section One

# Flow Measurement



WATER  
MEASUREMENT

### 1.1 Series 1000 Compact Flow Meters with Close Coupled Transmitter

The Emflux Series 1000 flow meter is a micro-controller based full bore type electromagnetic flow meter for use in a wide range of applications.

This flow meter accurately measures the flow rate of conductive liquids and slurries in closed pipes. Due to its simple and rigid design, the flow meter is an obstruction-less and maintenance-free instrument in place of conventional mechanical flow measuring devices.

The instrument is based on Faraday's law of electromagnetic induction, a magnetic field is generated by the instrument in the flow tube, the fluid flowing through this magnetic field generates a voltage that is proportional to the flow velocity, corresponding elect al output is provided with respect to measuring flow range.

#### Features

- Suitable for conductive liquid
- Full bore type
- ISO Standard Length
- Data Logging facility for 4000 records
- Local Indication through Graphics LCD
- Communication port (Optional)
- Empty pipe indication
- Maintenance free
- Simple & cost-effective construction



**EmFlux**  
Electromagnetic Flow Meters



#### How to buy:

Emflux A1000 Compact Meter	Order Code	Diameter	Group	List
<ul style="list-style-type: none"> <li>• Steel Bodied Flow tube</li> <li>• AS4087, PN16 Flanges</li> <li>• Stainless Steel Electrodes</li> <li>• Hard Ebonite Rubber Liner</li> <li>• 12V/24VDC Transmitter</li> <li>• Pulse output</li> </ul>	A1000-40	DN40	A2	2450.00
	A1000-50	DN50		2550.00
	A1000-80	DN80		2650.00
	A1000-100	DN100		2750.00
	A1000-150	DN150		3150.00
	A1000-200	DN200		3350.00
	A1000-250	DN250		4050.00
	A1000-300	DN300		4550.00
Emflux B1000 Compact Meter (Battery)	Order Code	Diameter	Group	List
<ul style="list-style-type: none"> <li>• Steel Bodied Flow tube</li> <li>• AS4087, PN16 Flanges</li> <li>• Stainless Steel Electrodes</li> <li>• Hard Ebonite Rubber Liner</li> <li>• Battery Powered Transmitter</li> <li>• Pulse output</li> </ul>	B1000-40	DN40	A2	1950.00
	B1000-50	DN50		2050.00
	B1000-80	DN80		2150.00
	B1000-100	DN100		2250.00
	B1000-150	DN150		2450.00
	B1000-200	DN200		2650.00

## Section One

# Flow Measurement



WATER  
MEASUREMENT

### 1.2 Series 1060 Compact Flow Meters with Remote Transmitter

The Emflux Series 1060 flow meter is a micro-controller based full bore type electromagnetic flow meter for use in a wide range of applications.

This flow meter accurately measures the flow rate of conductive liquids and slurries in closed pipes. Due to its simple and rigid design, the flow meter is an obstruction-less and maintenance-free instrument in place of conventional mechanical flow measuring devices.

The instrument is based on Faraday's law of electromagnetic induction, a magnetic field is generated by the instrument in the flow tube, the fluid flowing through this magnetic field generates a voltage that is proportional to the flow velocity, corresponding electrical output is provided with respect to measuring flow range.

#### Features

- Suitable for conductive liquid
- Full bore type
- ISO Standard Length
- Remote mount transmitter
- Communication port (Optional)
- Empty pipe indication
- Maintenance free
- Easy to install



**EmFlux**  
Electromagnetic Flow Meters



#### How to buy:

Emflux GM1060 Compact Flow Tube	Order Code	Diameter	Group	List
<ul style="list-style-type: none"> <li>• Suitable for conductive liquid</li> <li>• Full bore type</li> <li>• ISO Standard Length</li> <li>• Remote mount transmitter</li> <li>• Empty pipe indication</li> <li>• Maintenance free</li> <li>• Easy to install</li> </ul>	GM1060-50	DN50	A2	1850.00
	GM1060-80	DN80		1950.00
	GM1060-100	DN100		2050.00
	GM1060-150	DN150		2450.00
	GM1060-200	DN200		2850.00
	GM1060-250	DN250		3350.00
	GM1060-300	DN300		3850.00
Emflux M500 Transmitter	Order Code	Description	Group	List
<ul style="list-style-type: none"> <li>• M500 Flow Transmitter with keypad and screen, in metal enclosure.</li> </ul>	M500-MXXX	240VAC	A2	\$1,700.00
	M500-LXXX	24VAC		
	M500-PXXX	12VDC		
<ul style="list-style-type: none"> <li>• M500 Flow Transmitter with keypad and screen, in metal enclosure, with 4-20mA card fitted.</li> </ul>	M500-MXAX	240VAC+AO		\$1,850.00
	M500-LXAX	24VAC+AO		
	M500-PXAX	12VDC+AO		
Emflux Transmitter Cable	Order Code	Description	Group	List
<ul style="list-style-type: none"> <li>• Dual connecting cable, per meter (Maximum cable length is 100m)</li> </ul>	EMF-DUAL+PE		A2	\$16.00/m

## Section One

# Flow Measurement



WATER  
MEASUREMENT

### 1.2 Specifications for 1000 Series Flow Tubes

The Emflux A1000/B1000 and GM1060 share common dimensions for the flow tube.

Transmitter options will not affect the flange to flange measurements.



**EmFlux**  
Electromagnetic Flow Meters



*How to specify:*

Nominal Bore	Dimensions		Flow Range (M500/i500 Transmitter)		Flow Range (G400 Transmitter)	
	Flange Face (B)	Length (D)	Low Flow (lps)	High Flow (lps)	Low flow (lps)	High flow (lps)
DN40	135	200	0.05	9.4	0.05	7.52
DN50	150	200	0.08	14.7	0.08	11.76
DN80	185	200	0.20	38	0.20	30.4
DN100	215	250	0.31	58.9	0.31	47.12
DN150	280	300	0.71	132.5	0.71	106
DN200	335	350	1.26	235.6	1.26	188.48
DN250	405	450	1.96	368.2	1.96	294.56
DN300	455	500	2.83	530.1	2.83	424.08

Dimensions are +/- 1mm.

# Section One

## Pressure Measurement



WATER  
MEASUREMENT

### 1.3 Pressure Sensors

#### PT10 Pressure Sensors

The iC Pressure PT10 series of pressure transmitters are a low cost, compact and rugged device that are simple to install.

The transmitter comprises a stainless-steel housing, which is ideal for industrial environments, and features high quality pressure sensing elements. The sensor is suitable for use in a wide range of industrial and commercial applications, where accurate pressure measurement for liquids, gas and hydrocarbons is vital.



*How to buy:*

PT10 Pressure Sensor	Range	Order Code	Disc	List
iC Pressure Transducer, 4–20 mA, G ¼" Thread, Hirschman style plug	0-600kPa	PT10.06	A5	\$249.00
	0-1000kPa	PT10.10		
	0-1600kPa	PT10.16		
	0-3600kPa	PT10.36		



#### PT05 Pressure Sensors

The iC Pressure PT05 series of pressure transmitters are a low cost, compact and rugged device that are ideal for simple installation in harsh environments.

The IP67 rated, stainless steel housing and PE cable is ideal for industrial and agricultural environments where outdoor installations are required and feature high quality pressure sensing elements which provide long term hassle free operation.

A (LV) Low Voltage version for integration with the Aquamonix TWiN and RainWAN Control Systems, is preconfigured to provide accurate measurement in irrigation systems.

*How to buy:*

PT05 Pressure Sensor	Range	Order Code	Disc	List
iC Pressure Transducer, 4–20 mA, G ¼" Thread, IP67 with 10m of PE Cable.	0-300kPa	PT05.03	A5	\$249.00
	0-600kPa	PT05.06		
	0-1000kPa	PT05.10		
	0-1600kPa	PT05.16		

**\*\*LV models on request\*\***

## Section Three

# Monitoring Stations



REMOTE  
MONITORING

### 3.1 Web Logger Monitoring Stations with CloudBurst

Aquamonix Web Logger is a new generation Cellular Uplink & Data Logger, a wireless endpoint that is an innovative remote monitoring solution.

Connect the Web Logger Device to any compatible device where there is mobile phone coverage and you can instantly monitor data continuously. The device readings are automatically loaded to CloudBurst Data Portal, or can be seamlessly transmitted to your web site or billing system.

It is also possible to import the Data from the Web-Logger into the Aquamonix Central Control Systems, allowing for remote sensors to be recognized in advanced scheduling and control.

You can quickly report on your data, battery and signal strength and be alerted to any problems, it is from this portal that you can activate and deactivate SIMs, set logging and sensor parameters, position devices positions on maps, manage your end user logins and passwords and much more.

The Aquamonix Web Logger is available in a low-cost battery powered version with ultra-long life batteries, and fully potted for ease of installation, or is available in a Solar Powered version with long life Li-Ion Batteries for more permanent installations.

The Web Logger has a range of applications including,

- Environmental Monitoring
- Soil Moisture Monitoring
- Compliance Monitoring
- Metering & Billing

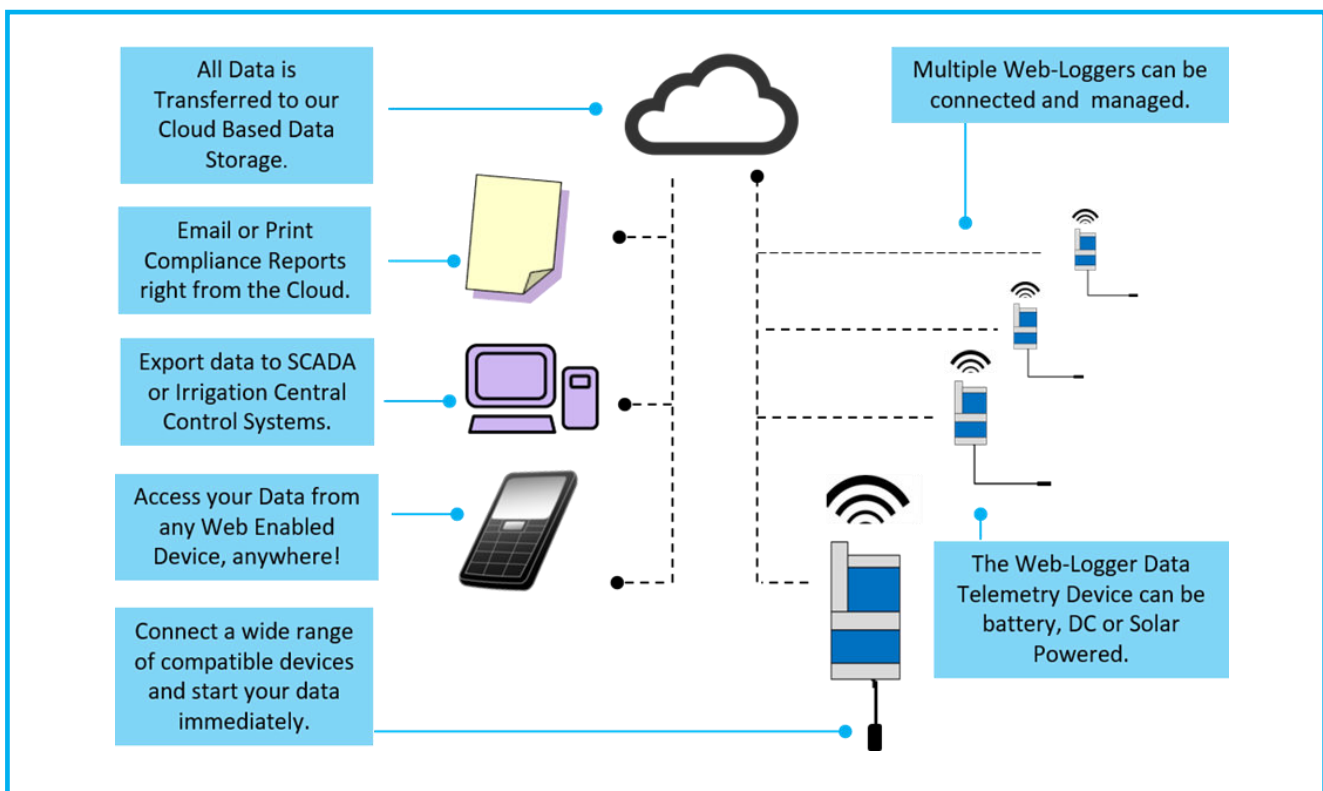



## Section Three

# Monitoring Stations



REMOTE  
MONITORING

### 3.1 Web Logger Monitoring Stations with CloudBurst

We offer the Web Logger in several ready to install options and build your own kits.

<i>How to buy:</i>				
Web Loggers	Description	Order Code	Disc	List
Battery Loggers	Web Logger, internal Battery Powered, in IP68 Enclosure, 1 x pulse, 1 x 4-20mA input.	WL.01.E	A2	\$899.00
	Web Logger, internal Battery Powered, in IP68 Enclosure, 1 x SDI-12 input	WL.01.S		
DC Loggers	Web Logger, requires DC Power source, in IP68 Enclosure, 1 x pulse, 1 x voltage input	WL.02.E		\$1,349.00
	Web Logger, requires DC Power source, in IP68 Enclosure, 1 x SDI-12 input	WL.02.S		
Cloudburst Subscription	12-month subscription, per device, at front	WL.SUB		\$299.00
Ready to install kits	Description	Order Code		List
Tank Monitoring	Simple tank monitoring kit, <ul style="list-style-type: none"> <li>○ Battery Web Logger</li> <li>○ PT40 Pressure Transducer</li> <li>○ 12 Months Cloudburst subscription</li> </ul>	CB.STM.01		\$1,249.00
	Simple tank monitoring kit, <ul style="list-style-type: none"> <li>○ DC Web Logger</li> <li>○ Sunkit Solar Panel</li> <li>○ PT40 Pressure Transducer</li> <li>○ 12 Months Cloudburst subscription</li> </ul>	CB.STM.02		\$1,799.00
Soil Moisture Monitoring	Simple soil moisture monitoring kit, <ul style="list-style-type: none"> <li>○ Battery Web Logger</li> <li>○ Zulu 600mm Probe</li> <li>○ 12 Months Cloudburst subscription</li> </ul>	CB.SMM.01		\$1,749.00
	Simple soil moisture monitoring kit, <ul style="list-style-type: none"> <li>○ Battery Web Logger</li> <li>○ Zulu 1000mm Probe</li> <li>○ 12 Months Cloudburst subscription</li> </ul>	CB.SMM.02		\$1,949.00
Simple Rain Fall Monitoring	Simple rain fall monitoring kit, <ul style="list-style-type: none"> <li>○ Battery Web Logger</li> <li>○ Tipping bucket Rain Gauge</li> <li>○ 12 Months Cloudburst subscription</li> </ul>	CB.RFM.01	\$1,449.00	
Simple Bore Monitoring	Simple bore monitoring kit, <ul style="list-style-type: none"> <li>○ Battery Web Logger</li> <li>○ PS50 Level Sensor with 30m cable</li> <li>○ 12 Months Cloudburst subscription</li> </ul>	CB.BHM.01	\$1,949.00	
	Simple bore monitoring kit, <ul style="list-style-type: none"> <li>○ Battery Web Logger</li> <li>○ PS50 Level Sensor with 50m cable</li> <li>○ 12 Months Cloudburst subscription</li> </ul>	CB.BHM.01	\$2,149.00	

# Section Three

## Monitoring Stations



### 3.2 Cloudburst Data Portal

With Cloudburst it's easy to display, analyse and utilize your data in powerful online graphs, reports or interface your data with your own systems using our API.

Cloudburst is capable of processing information from tens of thousands of remote devices and display the data in a format that helps you extract key data from a wide range of devices.

#### Features

##### Easy to access

Simply log in via web enabled device, anytime, anywhere and access your data.

##### Secure data collection and analysis

Integrates many sensor types and protocols and brings all your data together in one place.

##### Advanced alarms and notifications management

Automates alert messaging based on configurable thresholds, rules, and conditions to notify your contacts via text and/or e-mail.

##### Visualization of current conditions

Presents data in easy to understand maps, in close to real-time dashboards, charts, graphs and tables.

##### Hierarchical Access

Different password access levels ensure you can share data with stakeholders at the appropriate level of access.

##### Exception only reporting

Don't become overloaded with data, with Cloudburst it's easy to define "in range" parameters and report or alarm only when the data falls outside of these.



**Want a demo?**  
 Contact Aquamonix today for a in depth online demo of the Cloudburst portal, accessible from our website.

## Section Four

# Equipment Control Systems



IRRIGATION  
AUTOMATION

### 4.1 APIO Custom Control

The APIO (All Purpose Input/Output) Controller is able to be networked in small or very large Central Control Systems and will integrate with BMS Platforms and suitable third party hardware.

The APIO Controller operates with a range of power inputs, and is suitable for mains AC powered, AC or DC Generators or Solar DC Powered sites.

The APIO Controller can be supplied in several easy to specify formats, and can also be supplied in pre-built, pre-tested project packs.

The large daylight readable screen, and large direct access buttons, make the APIO easy to use even for the most technology shy operator.

The APIO integrates seamlessly with RainMan, Hybrid and GateKeeper Control Systems and can be used in a wide variety of applications including,

- Single or Multi Pump Control
- Engine Driven Pumps
- Booster System Integration
- Filtration Systems
- Injection & Dosing Systems
- Generator Integration
- Travelling Irrigators
- Storage Management
- Lakes & Ponds Management
- Infrastructure Management

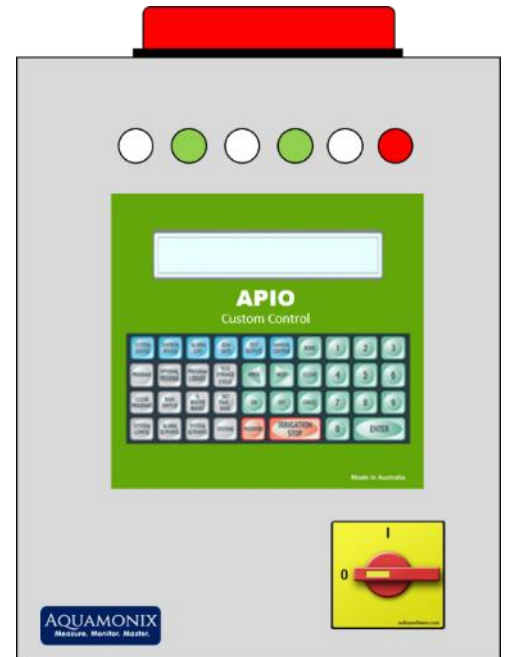

#### Connect

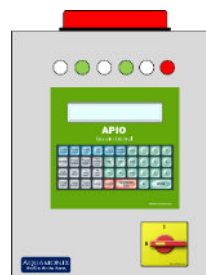

The APIO can be connected to devices locally or via a remote telemetry link.

#### Control

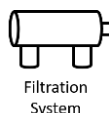

#### Monitor



## Section Four

# Equipment Control Systems



IRRIGATION  
AUTOMATION

### 4.1 APIO Custom Control

The APIO Custom Control is available in several ready to install formats or can be fully customized upon request.

Standard format for the APIO include,

Enclosure format D and E are complete with external strobe and isolating switch.



#### How to buy:

Booster Pump Configuration	Enclosure Format	Order Code	Disc	List
<ul style="list-style-type: none"> <li>Control up to 5 pumps/motor starts</li> <li>Control up to 4 external valves/switches</li> <li>Inputs Flow, pressure, level, kWh, current</li> </ul>	Panel Mount	AB.2.A	A3	\$2,999
	IP66 Poly Carb	AB.2.C		\$3,499
	IP65 Stainless 500	AB.2.D		\$4,899
	IP65 Stainless 800	AB.2.E		\$5,799
Lifting Station Configuration	Enclosure Format	Order Code	Disc	List
<ul style="list-style-type: none"> <li>Control up to 5 pumps/motor starts</li> <li>Control up to 4 external valves/switches</li> <li>Inputs multiple level switches and transducers, flow, kWh, current</li> </ul>	Panel Mount	AL.2.A	A3	\$2,999
	IP66 Poly Carb	AL.2.C		\$3,499
	IP65 Stainless 500	AL.2.D		\$4,899
	IP65 Stainless 800	AL.2.E		\$5,799
Aerator/Lakes & Ponds Configuration	Enclosure Format	Order Code	Disc	List
<ul style="list-style-type: none"> <li>Control up to 5 pumps/motor starts</li> <li>Control up to 4 external valves/switches</li> <li>Inputs wind speed/direction, level, water quality, kWh, current</li> </ul>	Panel Mount	AA.2.A	A3	\$2,999
	IP66 Poly Carb	AA.2.C		\$3,499
	IP65 Stainless 500	AA.2.D		\$4,899
	IP65 Stainless 800	AA.2.E		\$5,799

### APIO Technical Data

Functionality			
Start Outputs	5	Power Supply	External
Aux Outputs	4	Power inputs	AC or DC
Ext Alarm Outputs	4	Power Range	5 - 36V
Digital Inputs	8	HMI	Keypad & Screen
Analogue Inputs	4	Available Coms	Wired, Cellular, Radio, LoRaWAN, Sat Link, Fibre Optic
Serial Inputs	2	Operating Temp Range	0 - 73°C
Hardware Formats			
Panel Mount	Fascia with Keypad, Screen and PCB	IP65 Stainless Steel 500x500x300mm	Lockable wall mount with internal door, external indicators & strobe/ master switch
IP66 Poly Carb 407x356x212mm	Lockable, wall mount with internal door, no external indicators/switches	IP65 Stainless Steel 800x800x300mm	Lockable wall mount with internal door, external indicators & strobe/ master switch

Further technical data is available on request.



## Section Four

# Wireless Control



### 4.2 Remote control using RainWAN TPL transparent link.

The RainWAN TPL is a simple point to point wireless link that can be used to achieve a remote start signal from a wide range of inputs at the base node and transmit to a latching output on the remote node.



#### Features

- Low power
- Long range (+8km)
- Power input 12VDC
- Maintenance free
- Low cost

#### Base Module

- Transparent link
- Closed contact input or relay driven
- Indicator light on signal success
- Compact footprint

#### Remote Node

- Latching output with relay
- Compact footprint
- Status indicator



#### Applications

1. Remote pump/engine start
2. Remote valve actuator
3. Remote alarm
4. Tank fill/Sump empty

The RainWAN TPL node allows for localised long range, low power wireless networks to provide advanced control over broadacre applications, using the LoRa bandwidth.

#### LoRaWAN Protocol

LoRaWAN is a protocol specification built on top of the LoRa technology. It uses unlicensed radio spectrum in the Industrial, Scientific and Medical (ISM) bands to enable low power, wide area communication between remote sensors and gateways connected to the network, and provide bi-directional, secure, localised networks.

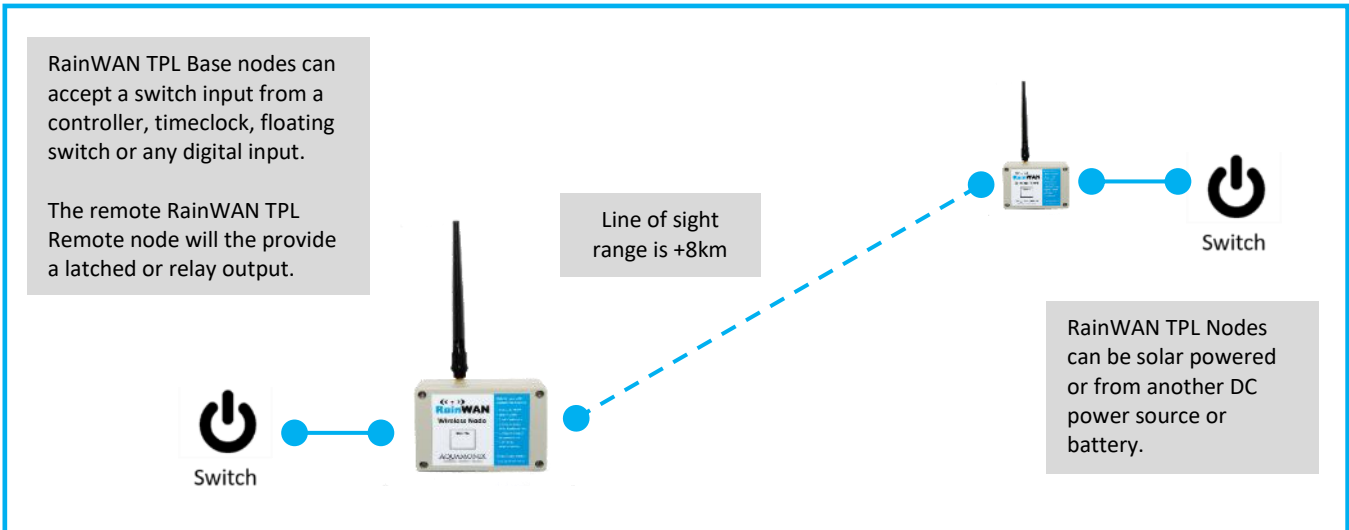

## Section Four

# Wireless Control



IRRIGATION  
AUTOMATION

### 4.2 Remote control using RainWAN TPL transparent link.

The RainWAN TPL wireless node is easy to specify and simple to install, and can be added to any of the range of Hybrid controller models.

All RainWAN Nodes are pre-tested and are supplied in a ready to install format.



<i>How to buy:</i>				
Base Node options	Description	Order Code	Disc	List
<ul style="list-style-type: none"> <li>RainWAN TPL Base Node, with 24VAC input relay, status indicator, IP65 Enclosure.</li> </ul>	Base Node Kit, with micro antenna	RiC.TPL01	A3	\$295.00
<ul style="list-style-type: none"> <li>RainWAN TPL Base Node, with float switch, IP65 Enclosure.</li> </ul>	Base Node Kit, with micro antenna	RiC.TPL02		\$395.00
Remote Node Options	Description	Order Code		List
<ul style="list-style-type: none"> <li>RainWAN TPL Pump node, with 12VDC output relay, status indicator, IP65 Enclosure.</li> </ul>	Pump Node Kit, with micro antenna	RiC.TPL03		\$395.00
<ul style="list-style-type: none"> <li>RainWAN TPL Valve node, for use with reCOIL Latching solenoid, IP65 Enclosure.</li> </ul>	Valve Node Kit, with micro antenna. reCOIL not included	RiC.TPL04	\$375.00	
Accessories	Description	Order Code	Disc	List
<ul style="list-style-type: none"> <li>12VDC plug pack transformer (no IP)</li> </ul>	Power supply	PS.12VDC.PP	A3	\$35.00
<ul style="list-style-type: none"> <li>5w Solar Panel and Pole Mount</li> </ul>	Solar panel with pole mount kit.	Sunkit.03		\$199.00
<ul style="list-style-type: none"> <li>6ah Battery</li> </ul>	Battery and cover	BAT.6		\$35.00
<ul style="list-style-type: none"> <li>Polycarb Enclosure Kit</li> </ul>	Wall Mount Polycarb enclosure	A884 Kit		\$149.00
<ul style="list-style-type: none"> <li>reCOIL 2 Way Latching solenoid</li> </ul>	Coil Kit	RC.12L		\$29.95
<ul style="list-style-type: none"> <li>reCOIL 3 Way Latching solenoid</li> </ul>	Coil Kit	RC.12L3W		\$39.95

## Section Five

# Wireless Irrigation Control



IRRIGATION  
AUTOMATION

## 5.4 Hybrid Control System with RainWAN LoRa wireless node.

The RainWAN LoRa wireless node is an expansion to the Hybrid Control System and allows for localised long range, low power wireless networks to provide advanced control over broadacre applications.

### LoRaWAN Protocol

LoRaWAN is a protocol specification built on top of the LoRa technology. It uses unlicensed radio spectrum in the Industrial, Scientific and Medical (ISM) bands to enable low power, wide area communication between remote sensors and gateways connected to the network, and provide bi-directional, secure, localised networks.

### RainWAN Wireless Control System

The RainWAN provides a transparent link for the Hybrid Control system to provide an advanced level of control and monitoring over large numbers of actuators and sensors in the field, up to the limits of the host controllers logic.

### Features

- Low power
- Long range (+8km)
- Power input 12VDC
- Maintenance free
- Low cost
- Expandable format

#### Base Module

- Transparent link to controller
- Serial connection
- DIN mount

#### Remote Node

- Latching output (2 or 3-way actuator)
- Flow, pressure, rain-gauge and soil moisture input.
- Pump start



### Hybrid Controller at a glance.

- Up to 95 Actuated valves can be managed from a single Hybrid controller, via remote RainWAN Nodes.
- Pump starts, injection systems and booster pumps can also be managed from the same controller, via remote RainWAN Nodes.
- Local connections to the Hybrid controller are also available.
- Multiple sensor inputs are available via local connections or remotely via the RainWAN Nodes.
- The Hybrid controller is sold web enabled ready for connection to the RainCloud Web app.

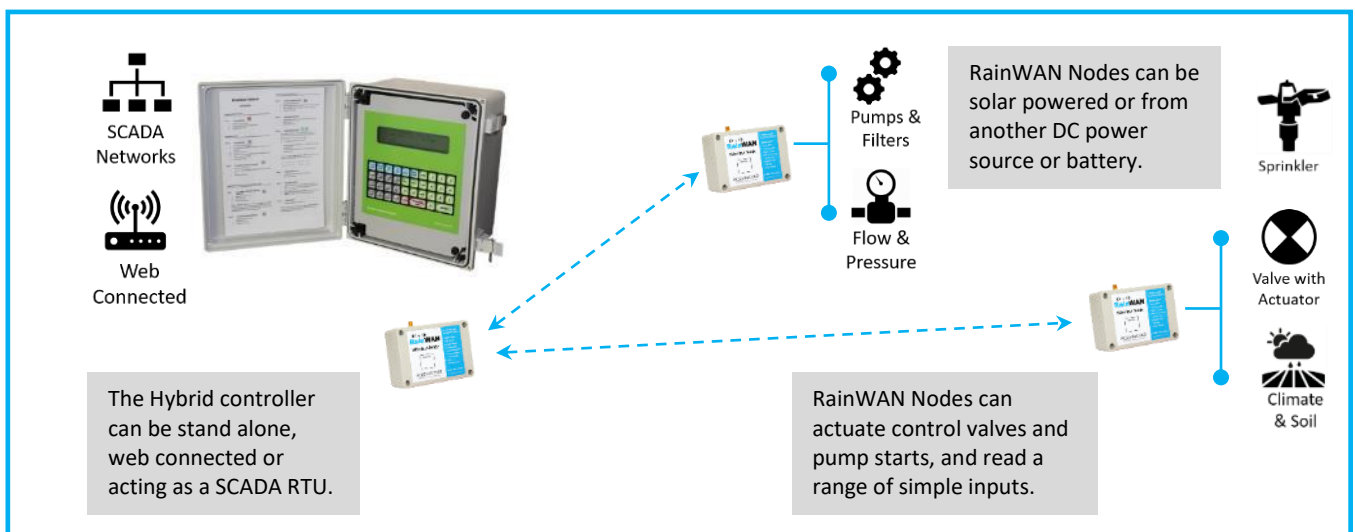

## Section Five

# Wireless Irrigation Control



IRRIGATION  
AUTOMATION

### 5.4 Hybrid Control System with RainWAN LoRa wireless node.

The RainWAN LoRa wireless node is easy to specify and simple to install, and can be added to any of the range of Hybrid controller models.

All RainWAN Nodes are pre-tested and are supplied in a ready to install format.



<i>How to buy:</i>				
Controller includes Base Module	Description	Order Code	Disc	List
<ul style="list-style-type: none"> <li>Hybrid Controller complete with,                             <ul style="list-style-type: none"> <li>Polycarb IP66 Enclosure</li> <li>Power Supply</li> <li>RainWAN Base Node</li> <li>Cellular Modem</li> </ul> </li> </ul>	Base station with web connection	HG.2.C.RWN	A3	\$5,495.00
<ul style="list-style-type: none"> <li>RainCloud Web App data plan</li> </ul>	Annual Subscription	CCS.RAINCLOUD.01		\$299.00
Remote Node options	Description	Order Code	Disc	List
<ul style="list-style-type: none"> <li>RainWAN Sensor node, no outputs, 2 x Pulse inputs, 1 x Pressure/Level input, 1 x SDI-12 input.</li> </ul>	Sensor only node, No solar panel or battery.	RiC-SN01	A3	Available soon
<ul style="list-style-type: none"> <li>RainWAN Single node, 1 x latching output, no inputs, complete with,                             <ul style="list-style-type: none"> <li>3W solar panel</li> <li>Battery</li> <li>Top of Pole Mount</li> </ul> </li> </ul>	Single output node, complete with solar panel, battery and top of pole mount.	RiC-RN01		\$395.00
<ul style="list-style-type: none"> <li>RainWAN Pump node, 1 x latching outputs, 1 x Pulse inputs, 1 x Pressure/Level input **Requires external relay**</li> </ul>	Pump start node, No solar panel or battery. No enclosure.	RiC-RN02		\$445.00
<ul style="list-style-type: none"> <li>RainWAN Dual node, 2 x latching outputs, 2 x Pulse inputs, 1 x Pressure/Level input, 1 x SDI-12 input.</li> </ul>	Dual output node, No solar panel or battery. No enclosure.	RiC-RN03		\$599.00
Accessories	Description	Order Code	Disc	List
<ul style="list-style-type: none"> <li>5w Solar Panel and Pole Mount</li> </ul>	Solar panel with pole mount kit.	Sunkit.03	A3	\$199.00
<ul style="list-style-type: none"> <li>6ah Battery</li> </ul>	Battery and cover	BAT.6		\$35.00
<ul style="list-style-type: none"> <li>Polycarb Enclosure Kit</li> </ul>	Wall Mount Polycarb enclosure	A884 Kit		\$149.00
<ul style="list-style-type: none"> <li>reCOIL 2 Way Latching solenoid</li> </ul>	Coil Kit	RC.12L		\$29.95
<ul style="list-style-type: none"> <li>reCOIL 3 Way Latching solenoid</li> </ul>	Coil Kit	RC.12L3W		\$39.95
<ul style="list-style-type: none"> <li>0-600kPa Low Power Pressure Sensor corded</li> </ul>	Pressure Sensor	PT05.06.LV		\$199.00
<ul style="list-style-type: none"> <li>0-5m Low Power Level Sensor with 10m cable</li> </ul>	Level Sensor	PT40.05.LV		\$199.00



## Section Ten

# Innovative Products

### 10.1 NEW iC Rain - Smart Rain Switch

The Aquamonix iC Rain is a new generation optical device, which replaces any mechanical, chemical, or conductive type rain switch. It can also be configured to emulate a tipping bucket rain gauge.

With no moving or perishable parts, it is far more rugged, sensitive and reliable than any other technology. The iC Rain senses water hitting its outside surface using beams of infrared light, it measures both rain accumulation and rain intensity, and will interrupt the scheduled watering after a pre-set amount of rainfall is detected.

The onboard software can then calculate the amount of rain and delay the restarting on the scheduled irrigation depending on the setting.

The iC Rain is available configured as a plug-in replacement for any "Click" type rain switch, or as rain gauge for use with remote telemetry or with advanced control systems allowing for user definable parameters to be accurately measure rainfall before interrupting scheduled watering, making a very versatile sensor for a range of applications.

The iC Rain is supplied pre-wired as a Rain Switch and will fit to any controller. It can also be ordered in a rain gauge version for use with the RainMAN Controllers allowing for rainfall to be accurately measured.

iC Rain Sensor	Order Code	Disc	List
<ul style="list-style-type: none"><li>iC Rain Sensor, 10m Cable, set as Rain Switch (blue disc)</li></ul>	ICR.S	A3	\$249.00
<ul style="list-style-type: none"><li>iC Rain Sensor, 10m Cable, set as Rain Gauge (green disc)</li></ul>	ICR.G		

#### iC Rain Operating Data

- Input Voltage; 10-30 VDC or 10-26VAC, 50v surge, reverse polarity protected to 50v
- Output Signal: Relay closure, N/O and N/C contacts, max load 1A, 24VDC
- Current Drain: 15mA nominal, 1.5mA in sleep mode, and up to 50mA with output on.
- Temp Range: -40 to +60 c



IRRIGATION  
AUTOMATION



#### It's not often that a truly NEW Innovative Water Saving Product Comes along.....!

Efficient management of water is critical for the future of irrigated agriculture as climate change and ongoing drought reduces the amount of available water.

#### Smart Technology!

The iC Rain senses water hitting its outside surface using beams of infrared light and will measure both rain accumulation and rain intensity, and will interrupt the scheduled watering after a preset amount of rainfall is detected, the iC-Rain then calculates evaporation from a predetermined rate before allowing irrigation to restart.

#### Works Fast!

Unlike conventional absorbent-disk style rain sensors, the iC Rain interrupts the watering cycle during a downpour, even before water accumulates..... This saves both water and time dealing with customer complaints!

#### Reliable!

With no moving or perishable parts it is far more rugged, sensitive and reliable than any other technology, it's compact and easy to install, it's totally sealed and impervious to corrosion, insects, or fouling from leaves or debris.

#### Easy to Use!

The iC Rain is supplied pre-wired as a Rain Switch and will fit to any controller, or can be ordered in a Rain Gauge version for use with the RainMan Control System allowing for rainfall to be accurately measured.

# Section Ten

## Innovative Products



### 10.3 reCOIL Solenoid Coils

The AQUAMONIX reCOIL™ is a low-cost alternative to costly OEM replacement coils.

Easy to use, it is ideal for the weekend warrior, or irrigation contractor, and is supplied in an easy to sell, easy to use kit that contains everything needed to replace a solenoid coil on most popular makes of valve!

The actuator is available as a 24VAC or DC Latching version and is a durable LOW POWER solenoid with a floating plunger and heavy duty potted case, with long insulated leads for ease of installation.



- 24VAC or DC Latching
- Heavy Duty Potted Metal Case
- Floating Plunger
- UNF 3/4" Thread (fit's Bermad, Galcon, K Rain, Orbit and many other Richdel Style Valves)
- Adaptor Kit (fit's RainBird, Hunter and Irritrol Valves)
- Supplied with Wire Connectors
- Easy to Install

*How to buy:*

PT10 Pressure Sensor	Model	Order Code	Disc	List
reCOIL Pack, includes heavy duty solenoid coil, wire connectors, 1 x adaptor suit Rainbird, 1 x adaptor suit Hunter, 1 x adaptor suit Irritrol.	24VAC	RC24	A3	\$19.95
	DC Latching	RC12L		\$24.95

**Operating Data**

Model Data **RC24**  
 Input Voltage 24VAC  
 Inrush Current 250mA  
 Holding Current 120mA  
 Max Pressure 600kPa

Model Data **RC12L**  
 Input Voltage 12VDC Latching  
 Resistance 5 ohms  
 Max Pressure 600kPa

## Section Ten

# Innovative Products



IRRIGATION  
AUTOMATION

### 10.4 Cable connectors and accessories

#### Cable Connectors

Aquamonix source the world's best cable connectors for use with our control systems. Specifically designed for use with low voltage systems, they have excellent wire restraint and sealing properties and the unique locking mechanism make them sure to give a stable connection every time!

#### Snaploc Cable Connectors



How to buy:

Snaploc connectors	Pack	Order	Disc	List
Snaploc wire connector, GEL filled, Dark Blue Cap up to 1.5mm <sup>2</sup>	25	BVS1	A5	\$1.99
Snaploc wire connector, GEL filled, Dark Blue Cap up to 4.0mm <sup>2</sup>	20	BVS2		\$2.99
Snaploc wire connector, GEL filled, Light Blue Cap up to 6.0mm <sup>2</sup>	10	BVS3		\$3.99

#### Kliploc Cable Connectors

#### Guaranteed Fastest No-Hassle Installation

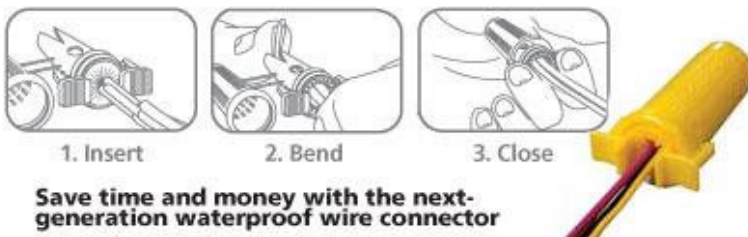

How to buy:

Kliploc connectors	Pack	Order	Disc	List
Kliploc wire connector, GEL filled,	24	LV9000	A5	\$0.99

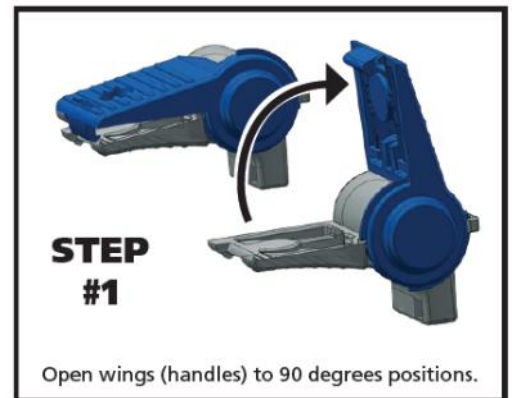



[www.aquamonix.com.au](http://www.aquamonix.com.au)

**Head Office & Manufacturing**

268 Milperra Rd, Milperra, New South Wales, 2214

**Sales & Distribution Centres**

4/783 Kingsford Smith Drv, Eagle Farm, Queensland, 4009

1/30 Oxleigh Drv, Malaga, Western Australia, 6090

**Regional Offices**

37-41 William St, Tatura, Victoria, 3616

2/34 Park Ave, Coffs Harbour, New South Wales, 2450

**Contact us**

Call local 1300 797 246 or Int'l +61 8 9477 1188  
[sales@aquamonix.com.au](mailto:sales@aquamonix.com.au)



[www.aquamonix.co.nz](http://www.aquamonix.co.nz)

**Aquamonix NZ**

PO Box 69278, Lincoln,  
Canterbury, 7640, New Zealand

**Contact us**

Call local 0800 278 260  
[nzsales@aquamonix.co.nz](mailto:nzsales@aquamonix.co.nz)